



# NOISE SUPPRESSOR

SERVICE to 500°F

- Standard sizes 3/8" to 8". Consult Factory for additional sizes
- Effective over a broad frequency band (up to 12,000 Hz)
- Noise attenuation up to 26 dBA
- Expansion fittings not required
- Straight through design minimizes pressure drop, permitting normal valve sizing

Canadian Registration # CSA-OH 6266.5R1C

## NOISE SUPPRESSORS

### APPLICATION DATA

- Steam Pressure Reduction Stations where Noise Reduction is Desired

### SUPPRESSOR ENDS

INLET ANSI	OUTLET ANSI
NPT	NPT
NPT	150#
NPT	300#
150#	150#
300#	150#
300#	300#

NOTE: ANSI 150# Flanges are flat faced.

It is recommended that the Noise Suppressor be insulated to reduce condensation formation in the acoustic material.

SIZING INFO  
PAGE 193

## DIMENSIONS inches (mm) AND WEIGHTS pounds (kg) INLET SIZE 2 1/2" TO 8"

NOMINAL PIPE SIZE			D*-INSTALLED LENGTH		APPROX. WEIGHT		Average Attenuation dBa†
A INLET	B OUTLET	C SHELL	150# x 150#	300# x 300#	150# x 150#	300# x 300#	
2 1/2 (65)	4 (100)	6 (150)	47 (1010)	47 (1194)	97 (44)	109 (49)	16
2 1/2 (65)	5 (125)	6 (150)	47 1/2 (1200)	48 1/8 (1222)	99 (45)	115 (52)	16
3 (80)	4 (100)	6 (150)	47 (1009)	47 3/4 (1214)	99 (45)	103 (47)	14
3 (80)	5 (125)	6 (150)	47 1/2 (1207)	48 1/4 (1227)	101 (46)	119 (54)	14
3 (80)	6 (150)	8 (200)	58 5/16 (1488)	59 5/16 (1506)	150 (68)	181 (82)	19
4 (100)	5 (125)	6 (150)	47 3/4 (1214)	48 1/8 (1222)	105 (48)	129 (59)	12
4 (100)	6 (150)	8 (200)	54 3/4 (1392)	55 1/2 (1410)	162 (74)	178 (81)	16
4 (100)	8 (200)	10 (250)	66 1/4 (1684)	67 (1702)	256 (116)	299 (134)	21
5 (125)	6 (150)	8 (200)	55 1/4 (1405)	56 (1422)	180 (82)	167 (76)	14
5 (125)	8 (200)	10 (250)	66 3/4 (1696)	67 1/2 (1715)	289 (131)	247 (130)	19
5 (125)	10 (250)	12 (300)	89 5/16 (2268)	90 5/16 (2294)	455 (207)	428 (194)	26
6 (150)	8 (200)	10 (350)	66 3/4 (1697)	67 1/2 (1715)	295 (134)	299 (136)	17
6 (150)	10 (250)	12 (300)	83 3/4 (2129)	84 3/4 (2154)	451 (205)	490 (222)	24
8 (200)	10 (250)	12 (300)	84 1/4 (2141)	85 1/4 (2166)	468 (213)	507 (230)	21

\* ±1/4" for 8" Shell and under, otherwise ± 3/8".

† Consult factory for specifics.

NOISE SUPPRESSOR

# NOISE SUPPRESSOR

## SPECIFICATION

Noise Suppression equipment shall be of the dissipative reactive type. Suppressor shall not induce back pressure. It shall have expanded outlet flange for attachment to downstream piping. Equipment shall provide a minimum of 10 dBA reduction in noise. Installation must be insulated.

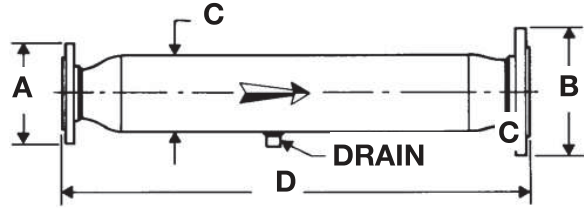

## MATERIALS OF CONSTRUCTION

Pressure Shell .....Welded Steel Components  
Acoustic Material .....Stainless Steel

## MAXIMUM OUTLET VELOCITY

feet per minute  
(meters per minute)

NOMINAL PIPE SIZE	MAXIMUM VELOCITY
0 - 2 (0 - 51)	17,000 (5182)
2 1/2 - 8 (64 - 203)	11,000 (3353)
>8 (>203)	9,000 (2734)

## DIMENSIONS inches (mm) AND WEIGHTS pounds (kg) INLET SIZES 3/8" TO 2"

NOMINAL PIPE SIZE			D* - INSTALLED LENGTH			APPROX. WEIGHT					Average Attenuation dBa†
A INLET	B OUTLET	C SHELL	NPTxNPT	150x150#	300x300#	NPT x NPT	150# x 150#	300# x 300#	150# x 150#	300# x 300#	
3/8 (10)	3/4 (20)	2 (50)	18 (457)								16
3/8 (10)	1 (25)	2 (50)	18 5/16 (465)								16
3/8 (10)	1 1/2 (40)	3 (80)	26 5/8 (676)								22
1/2 (15)	1 (25)	2 (50)	21 5/16 (541)	19 7/8 (505)	20 5/16 (516)				12 (5.4)	13 (5.9)	12
1/2 (15)	1 1/4 (32)	2 1/2 (65)	23 15/16 (608)	22 1/8 (561)	22 5/8 (575)				15 (6.8)	17 (7.7)	15
1/2 (15)	1 1/2 (40)	3 (80)	27 1/16 (687)	25 5/8 (650)	22 1/16 (662)	19 (9)	26 (12)	29 (13)			20
3/4 (20)	1 1/4 (32)	3 (80)	28 3/8 (721)	26 5/8 (676)	27 1/8 (689)	19 (9)	25 (11)	28 (13)			16
3/4 (20)	2 (50)	3 (80)	28 5/8 (727)	26 5/8 (676)	27 1/8 (689)	19 (9)	31 (14)	34 (15)			16
1 (25)	1 1/2 (40)	3 (80)	25 3/4 (654)	23 7/8 (607)	24 3/8 (619)	18 (8)	27 (12)	31 (14)			12
1 (25)	2 (50)	4 (100)	36 (914)	34 (864)	34 1/2 (876)	28 (13)	33 (15)	36 (16)			13
1 1/4 (32)	2 (50)	4 (100)	36 1/16 (916)	34 1/16 (86)	34 5/8 (889)	29 (13)	34 (15)	38 (17)			14
1 1/4 (32)	3 (80)	4 (100)		34 5/16 (872)	35 (889)		34 (15)	39 (18)			14
1 1/2 (40)	3 (80)	4 (100)		31 7/16 (798)	32 1/16 (814)		31 (14)	34 (15)			12
2 (50)	3 (80)	4 (100)		31 1/2 (800)	32 1/8 (816)		37 (17)	45 (20)			10
2 (50)	4 (100)	5 (125)		39 3/4 (1010)	40 3/8 (1026)		67 (30)	69 (31)			14

\* ±1/4" for 8" Shell and under, otherwise ± 3/8".

† Consult factory for specifics.

NOISE SUPPRESSOR

# MUFFLING ORIFICE PLATES (MOPS)

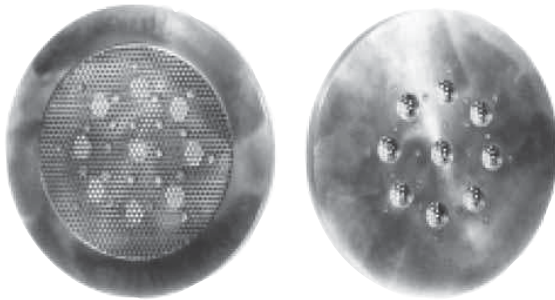

**INLET**  
**MUFFLING ORIFICE**

**OUTLET**  
**MUFFLING ORIFICE**

- Reduces noise by 6 dBA to 12 dBA
- Engineered for each application
- Designed to fit between ANSI flanges (DIN upon request)
- For noise reduction estimates, consult your Representative.

Canadian Registration # CSA-OH 6266.5R1C

## MATERIALS OF CONSTRUCTION

Plate .....Steel ASTM A285-78 Gr. C.

Disc .....St. St. 302-2B

## APPLICATION DATA

- Spence Pressure Regulators or Control Valves where noise reduction is desired

SIZING INFO  
PAGE 193

## SPECIFICATION

A Muffling Orifice Plate to be constructed of materials suitable for the installation and compatible with the piping. Generally, it is to be of steel construction with stainless steel plate welded to the primary plate. The orifices are to be on the stainless steel plate. Orifice plates are to be designed for installation between two ANSI flanges in the enlarged piping downstream of the regulator or noise suppressor. Muffling Orifice Plates are to be designed to provide between 6 to 12 dBA of noise reduction on a high flow PRV.

## DIMENSIONS inches (mm)

Muffling Orifice Plates			
Size	Rating	OD	
		inch	mm
1	125/150	4.25	108
	250/300	2.81	71
	600	2.00	51
1-1/4"	125/150	4.62	117
	250/300	3.00	76
	600	2.50	64
1-1/2"	125/300	5.00	127
	250/300	3.62	92
	600	2.88	73
2"	125/150	6.00	152
	250/300	4.19	106
	600	3.62	92
2-1/2"	125/150	7.00	178
	250/300	4.94	125
	600	4.12	105
3"	125/150	7.50	191
	250/300	5.69	145
	600	5.00	127
4"	125/150	9.00	229
	250/300	6.94	176
	600	6.19	157
5"	125/150	10.00	254
	250/300	8.31	211
	600	7.31	186
6"	125/150	11.00	279
	250/300	9.69	246
	600	8.50	216
8"	125/150	13.50	343
	250/300	11.94	303
	600	10.62	270
10"	125/150	16.00	406
	250/300	14.06	357
	600	12.75	324
12"	125/150	19.00	483
	250/300	16.44	418
	600	15.00	381
14"	125/150	21.00	533
	250/300	18.94	481
	600	16.25	413
16"	125/150	23.50	597
	250/300	21.06	535
	600	18.12	460
18"	125/150	25.00	635
	250/300	23.31	592
	600	23.00	584

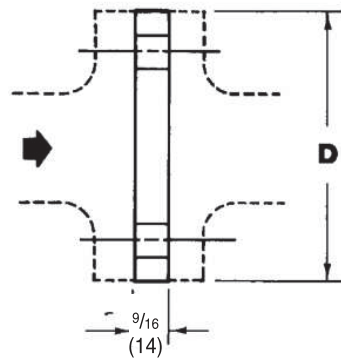

**ANSI 125 & 150 FLANGED**

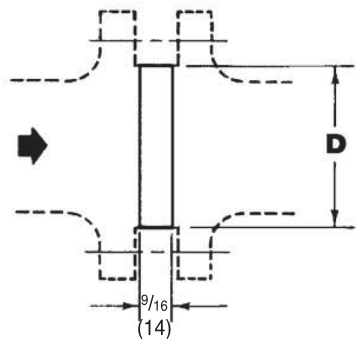

**ANSI 250, 300 & 600 FLANGED**

MUFFLING ORIFICE

# STEAM PRESSURE REDUCING STATION NOISE REDUCTION

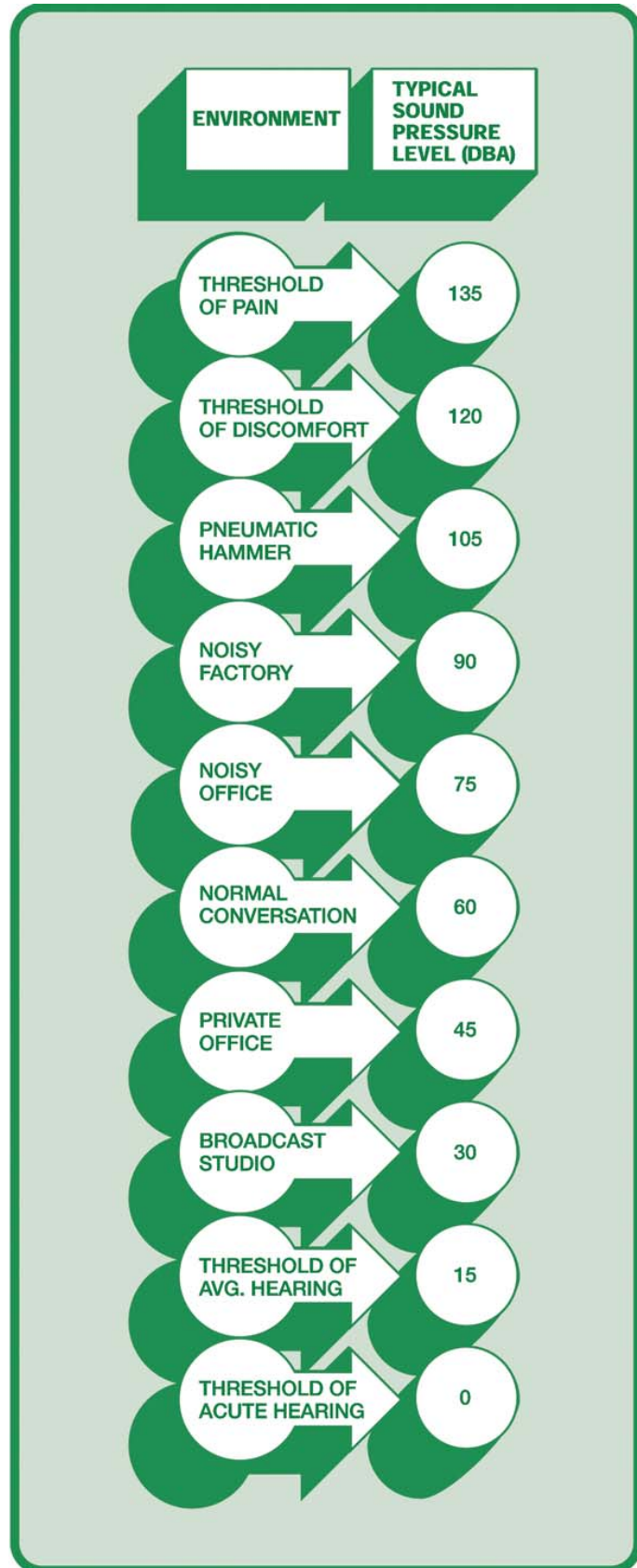

NOISE REDUCTION